

OPTION 4

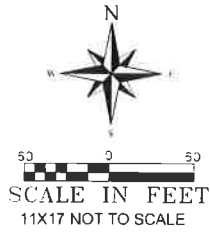

EXISTING OVERHEAD
POWER LINES

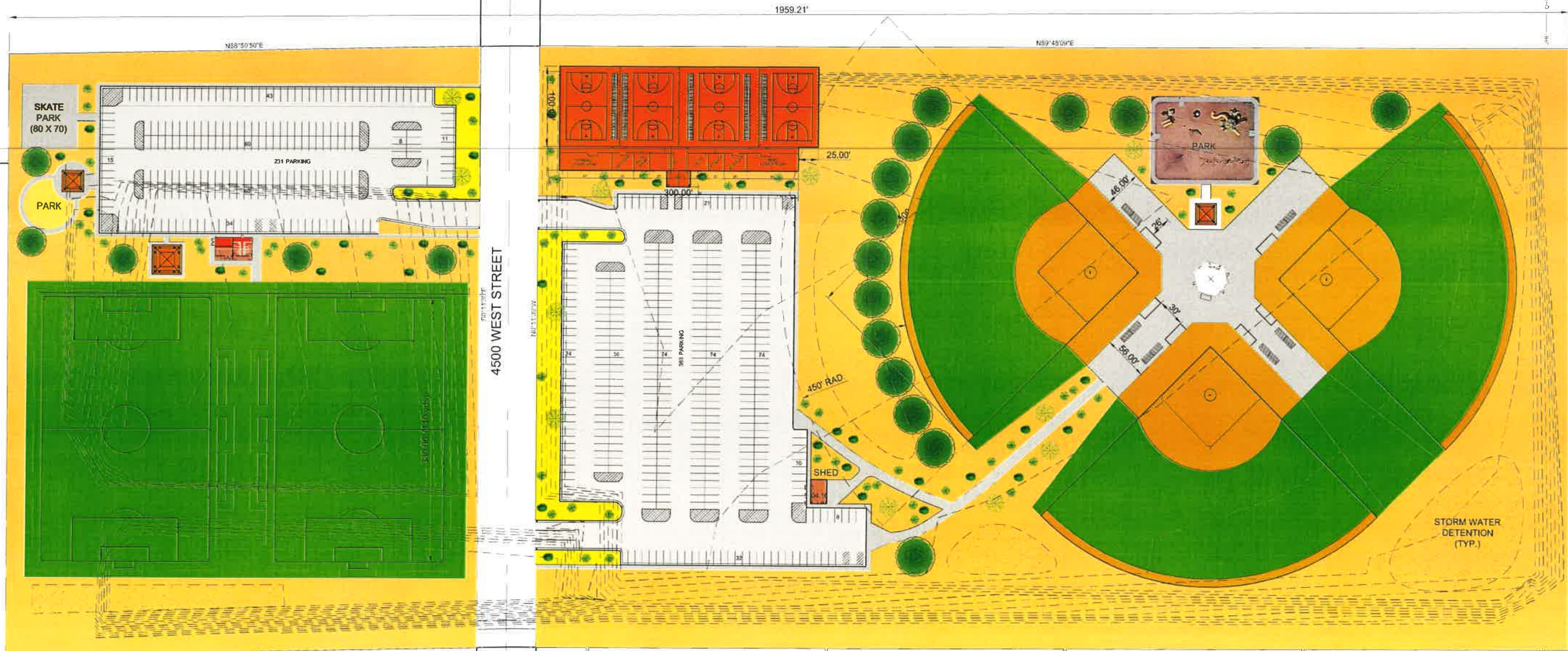

OPTION 6

—FUTURE
FL= 5502.87

FL= 5505.27

FL= 5505.26

—FUTURE QUICHAPA DRAINAGE
CHANNEL IMPROVEMENT LIMITS

FL= 5507.25

CENTERLINE OF QUICHAPA
DRAINAGE CHANNEL

FL= 5509.24

FL= 5509.23

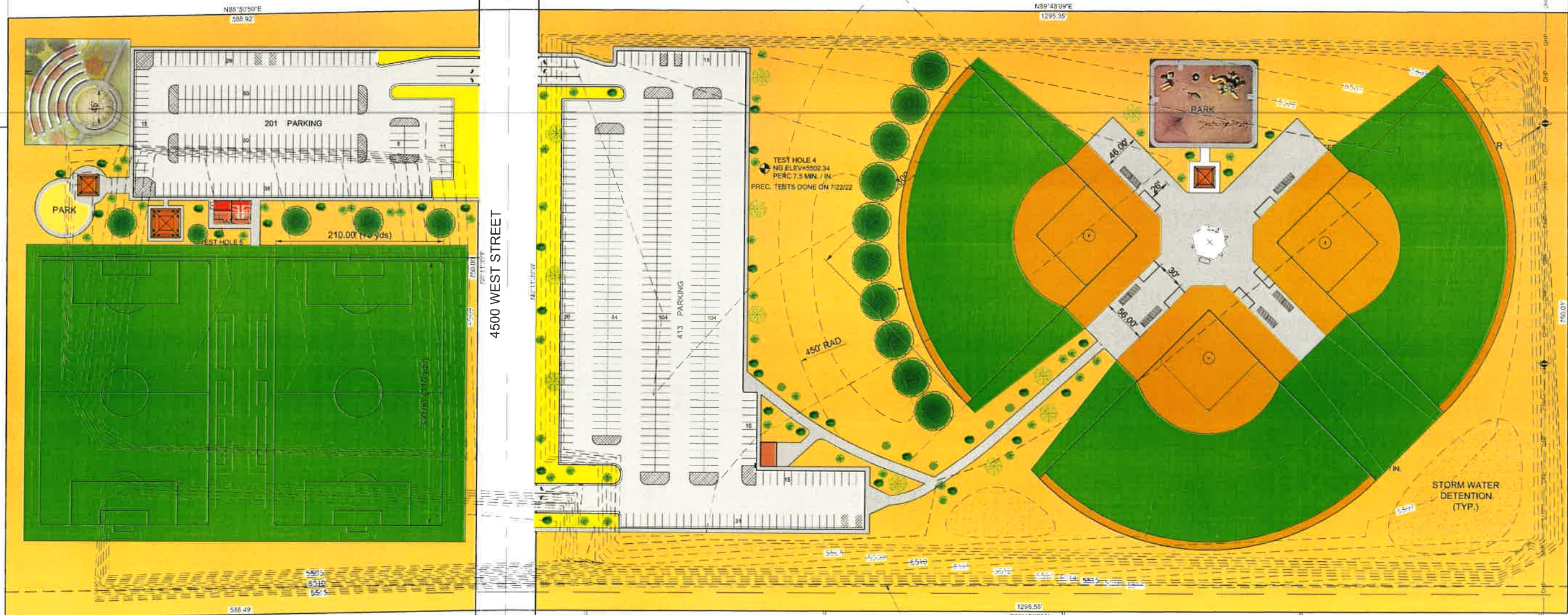
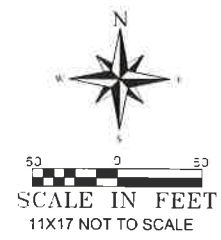

OPTION 7

FUTURE
FL= 5502.87

588.92
588°50'50"W

FL= 5503.27

FL= 5506.26

FUTURE QUICHAPA DRAINAGE
CHANNEL IMPROVEMENT LIMITS

FL= 5507.25

CENTERLINE OF QUICHAPA
DRAINAGE CHANNEL

FL= 5508.24

FL= 5509.23

EXISTING OVERHEAD
POWER LINES

1959.21'

N88°50'50"E
588.92

N89°48'09"E
1295.35

201 PARKING

473 PARKING

PARK

210.00' (19 yds)

450' RAD

STORM WATER
DETENTION
(TYP.)

TEST HOLE 4
NG ELEV=5502.34
PERC 7.5 MIN / IN
PREC. TESTS DONE ON 7/28/22

48.00'

58.00'

50' 2022'E

50' 2022'E

50' 2022'E

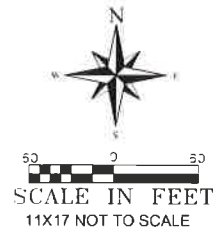

OPTION 11

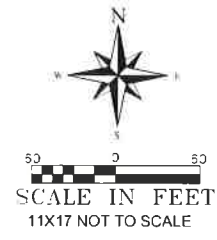

OPTION 13